

C. **PRESENTATION/DISCUSSION ITEMS**

1. **TITLE:** Update on the Athletic Facilities Master Plan

BACKGROUND: The Mira Costa renovation project, funded by Bond Measure BB, includes many major improvements. One of those improvements is a new state-of-the-art science facility and another is a beautiful new quad area for the campus. These additions, plus many others, will do a great deal to transform and improve the Mira Costa High School campus. The school's tennis courts must be moved to accommodate these additions to the campus. The Manhattan Beach Athletic Foundation (MBAF) has raised funds to move the tennis courts and upgrade the field facilities and has been working on developing plans on how best to improve those facilities.

At the Board of Trustees meeting on September 15 2010, the Board received community input on these plans. Since that time, the MBAF has been holding meetings with Mira Costa coaches and community athletic organizations. This group met four times and worked with architects in an effort to maximize field space and provide the best possible field plan for Mira Costa students and the community. There are many challenges to this task, including limited field space, limited budget and a great deal of need for high quality fields and courts.

Mr. Gary Wayland, President of the MBAF, will present the recommendation of the committee. The presentation will include an overview of the proposed plan, the projected budget for the plan, and the rationale for the plan. The Board of Trustees will not take action on the plan at this meeting. The Board will direct staff regarding the process by which the Board of Trustees will discuss the plans for the Mira Costa fields project, hear community input, and eventually receive a staff recommendation for action.

The plans for the overall BB improvement project have already been submitted to the Department of State Architect (DSA) and are in the long process for interaction, feedback and approval. Final approval for those plans is expected in March 2011. The District will submit the plans for the fields to DSA after the Board has approved a final plan and the budget associated with that plan.

ACTION RECOMMENDED: No action is requested.

PREPARED BY: Dr. Michael D. Matthews, Superintendent

DATE OF MEETING: November 17, 2010

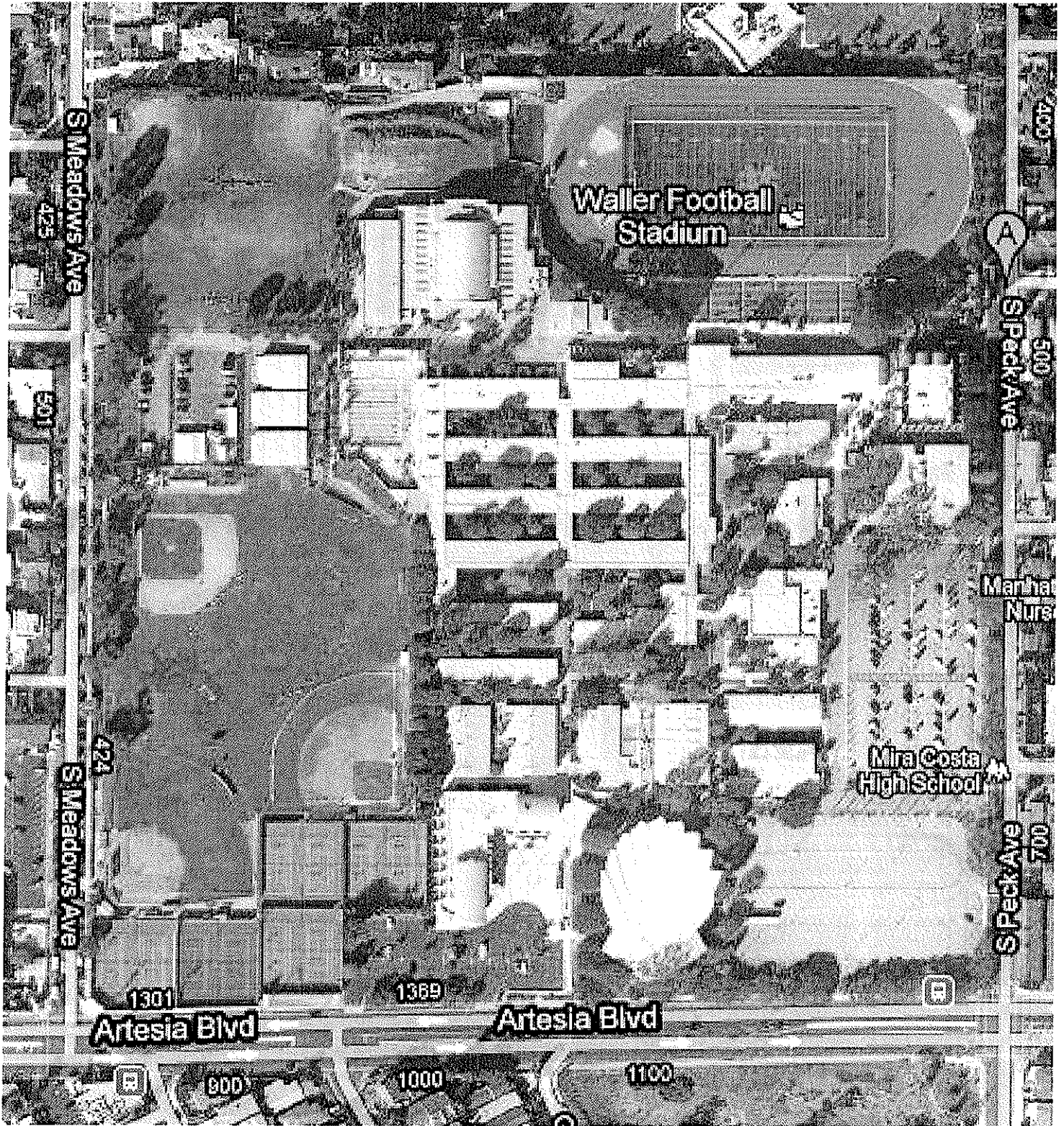

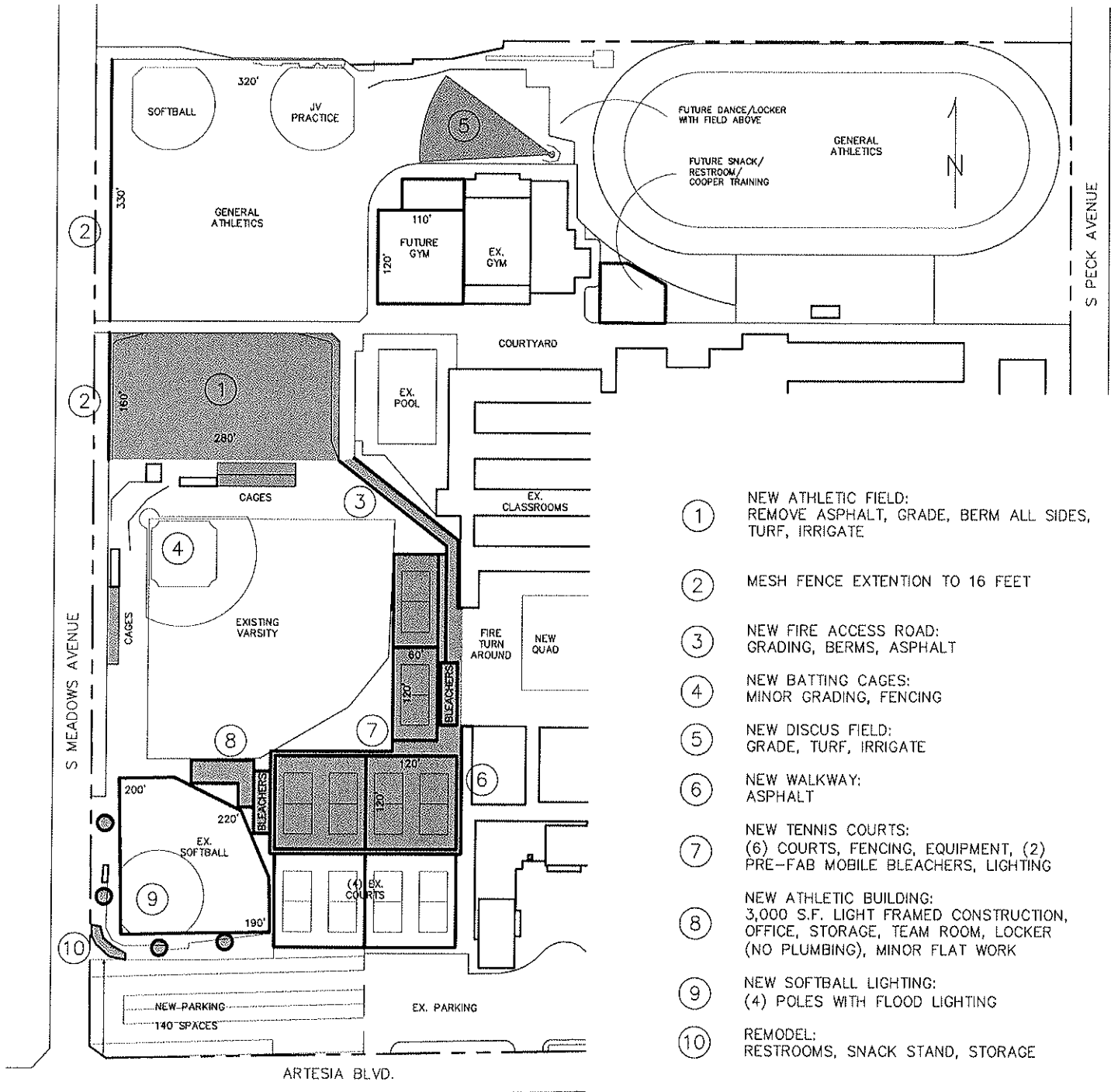

- ① NEW ATHLETIC FIELD:
REMOVE ASPHALT, GRADE, BERM ALL SIDES,
TURF, IRRIGATE
- ② MESH FENCE EXTENTION TO 16 FEET
- ③ NEW FIRE ACCESS ROAD:
GRADING, BERMS, ASPHALT
- ④ NEW BATTING CAGES:
MINOR GRADING, FENCING
- ⑤ NEW DISCUS FIELD:
GRADE, TURF, IRRIGATE
- ⑥ NEW WALKWAY:
ASPHALT
- ⑦ NEW TENNIS COURTS:
(6) COURTS, FENCING, EQUIPMENT, (2)
PRE-FAB MOBILE BLEACHERS, LIGHTING
- ⑧ NEW ATHLETIC BUILDING:
3,000 S.F. LIGHT FRAMED CONSTRUCTION,
OFFICE, STORAGE, TEAM ROOM, LOCKER
(NO PLUMBING), MINOR FLAT WORK
- ⑨ NEW SOFTBALL LIGHTING:
(4) POLES WITH FLOOD LIGHTING
- ⑩ REMODEL:
RESTROOMS, SNACK STAND, STORAGE

MIRA COSTA ATHLETIC MASTER PLAN

11/3/10

BID

3.

C. **PRESENTATION/DISCUSSION ITEMS**

2. **TITLE:** Presentation from Stacia Costa, Energy Education Consultant, Reviewing Status of Implementing the Energy Education Program.

BACKGROUND: Energy Education is a company specializing in changing an organization's behavior and attitudes toward energy usage, resulting in long term energy savings. On June 16, 2010 the board approved the four year contract with Energy Education Inc. and on September 15, 2010 the board approved Stacia Costa to be the District's Energy Education Consultant. This presentation is for the board's information and reviews the start up and progress of implementing the Energy Education process.

ACTION RECOMMENDED: No action is recommended.

PREPARED BY: Steve Romines

DATE OF MEETING: November 17, 2010



Energy Education Update

November 17, 2010
MBUSD Board Meeting
Stacia Costa, Energy Ed. Specialist

MBUSD Energy Education Program

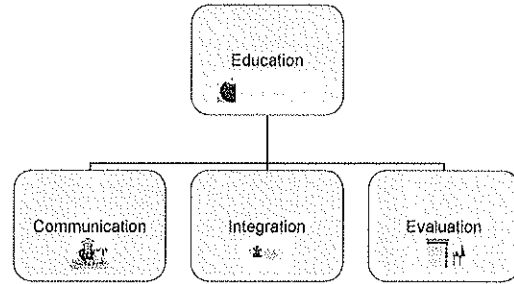

Education

- EE Consultant Contact 1 X Week
- 10-15 Site Audits a Week
 - Why? Who knows? Who cares?
 - HVAC, Electricity, Water, Gas Usage
- National Training Conference – Fort Worth
- Monthly Meetings with ES, RB and PV
- Energy Education Portal and Blogs

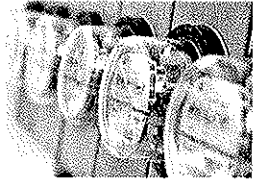

Communication

- Building/Site Administrator Meetings
- Maintenance/Operations Meetings
- Regular contact with all Custodial Staff
- Staff Meetings
 - Reminder Notes
 - Audit Forms to Custodians and Administrators

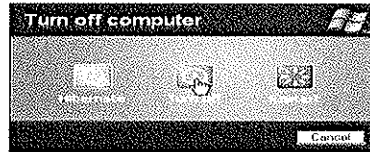

Integration and Resource Development

Energy Star Partner



Publicity



Cool Schools Program



Matrix Program – Southern California Edison



Evaluation

- ECAP Energy Cap Avoidance Program

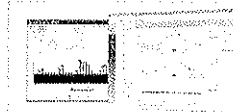

- How are we doing? – Data Releases by site
- Staff and Community Feedback

D. PRESENTATION/ACTION ITEMS

2. **TITLE:** Comprehensive School Safety Plans, Emergency Preparedness Procedure Handbooks.

BACKGROUND: Per Ed. Code EC32280, each school in a district is required to maintain a comprehensive school safety plan and update these plans annually. Each plan has required elements. All of our schools have completed the updates to these specifications. An additional requirement is for each school and district office to have clear procedures to follow in the event of emergencies. These procedures must be clearly posted in all classrooms, school offices and the district office. This year we have revised the procedure handbooks and created two documents; one for classrooms, and a more extensive one for administrative use.

ACTION RECOMMENDED: Approve safety plans and publication of Emergency Procedure Reference Guide and Emergency Procedure Administrator's Reference Guide. Funds to be paid from General Fund (Tier 3 Program, Carl Washington Safety Block Grant), Acct. #01.0-06405.0-0-83000-4310-011. This item has not been budgeted.

FISCAL IMPACT: Approximately \$3,900.00. Funds to be paid from General Fund (Tier 3 Program, Carl Washington Safety Block Grant), Acct. #01.0-06405.0-0-83000-4310-011. This item has not been budgeted.

PREPARED BY: Ellyn Schneider, Executive Director, Student Services

APPROVED BY: _____

Steve Romines

Assistant Superintendent, Administrative Services

DATE OF MEETING: November 17, 2010

AGENDA NOTE AGENDA NOTE AGENDA NOTE

E. CONSENT CALENDAR

1. **TITLE:** Student Services Teacher on Special Assignment for remainder of 2010/2011 School Year

BACKGROUND: Under the direction of the Executive Director, Student Services, to provide support for both site-based and District instructional/educational program in developing a three-tiered intervention model. This highly skilled teacher will provide instructional leadership, teacher and curriculum development directed toward refining a three tiered intervention model that will support implementation of an RtI model of instruction in the elementary school. The RtI model provides academic interventions and differentiated instruction to all students, particularly those students who are struggling with mastery. It defines the increasingly more involved strategies for each tier. The tiers are considered early intervention and require that data be taken regularly. If successful, these interventions can successfully prevent the need for special education for some students. Once the TOSA has identified strategies and interventions, they will develop an implementation plan with each site administrator that meets that sites needs. The implementation plan will include staff development related to implementation of the strategies.

ACTION RECOMMENDED: Approve Student Services Teacher on Special Assignment, from approximately December 1, 2010 through June 30, 2011. Funds to be paid from ARRA funds, acct. #01.0-33130.0-11100-21000-1110-0000013. This item has been budgeted.

FISCAL IMPACT: Approximately \$48,500.00. Funds to be paid from ARRA funds, acct. #01.0-33130.0-11100-21000-1110-0000013. This item has been budgeted.

PREPARED BY: Ellyn Schneider, Executive Director, Student Services

APPROVED BY: _____

Steve Romines
Assistant Superintendent, Administrative Services

DATE OF MEETING: November 17, 2010

AGENDA NOTE AGENDA NOTE AGENDA NOTE

E. CONSENT CALENDAR

2. **TITLE:** Job Description for Teacher on Special Assignment

BACKGROUND: Attached is the job description for Teacher on Special Assignment, for the purpose of developing a three-tier RtI (Response to Intervention) process in elementary schools.

ACTION RECOMMENDED: Approval is requested.

PREPARED BY: Ellyn Schneider, Executive Director, Student Services

DATE OF MEETING: November 17, 2010

Manhattan Beach Unified School District Teacher on Special Assignment (TOSA)

Developing a Three Tier RtI (Response to Intervention) Process in
Elementary Schools
Funded by Special Education ARRA funds

Description of Position: Under the direction of the Executive Director, Student Services, to provide support for both site-based and District instructional/educational program in developing a three-tiered intervention model. This highly skilled teacher will provide instructional leadership, teacher and curriculum development directed toward refining a three tiered intervention model that will support implementation of an RtI model of instruction in the elementary school. The RtI model provides academic interventions and differentiated instruction to all students, particularly those students who are struggling with mastery. It defines the increasingly more involved strategies for each tier. The tiers are considered early intervention and require that data be taken regularly. If successful, these interventions can successfully prevent the need for special education for some students. Once the TOSA has identified strategies and interventions, they will develop an implementation plan with each site administrator that meets that sites needs. The implementation plan will include staff development related to implementation of the strategies.

Essential Duties and Responsibilities: The duties listed below are characteristic of the type and level of work assigned to the position. A TOSA may perform all or some of the duties listed below, as well as other related duties.

Planning and Preparation:

1. Plans, organizes and schedules staff development programs, curriculum and instruction projects, and technical assistance efforts that are (a) responsive to the needs of the District, schools, site administrators and teachers and (b) reflect research, "best practices," and relevant federal and state policies, laws and RtI initiatives.
2. Drafts program proposals and plans, and related budgets or cost analysis, for review by the Executive Director, Student Services.

Implementation:

3. Manages professional development and school intervention curriculum and instruction practices and services including monitoring and adjusting services, as needed.
4. Develops and manages related budget, with support from the Executive Director, Student Services.
5. Creates effective flyers, brochures and related program materials and means of communication.

Data Analysis:

6. Analyzes and uses assessment data to identify program needs and to evaluate, improve and report on program effectiveness.

7. Uses knowledge of state standards and standards-based assessment, scoring, and reporting methods and current remediation programs to assist in the design of staff development and site curriculum and intervention programs.
8. As appropriate, organizes and interprets assessment data to support student instruction and learning.

Communication:

9. Communicates clearly and effectively with other staff members, school District colleagues, and parents.
10. Uses a variety of communication methods, including e-mail, and web-based strategies to support professional development and site/District projects.
11. Writes clear, well-organized documents, including reports and proposals.
12. Responds constructively and in a timely manner to requests, questions, suggestion, and concerns from administrative, staff, parents and community.

Professional Leadership and Conduct:

13. Provides leadership and support to the schools and District in developing and implementing curriculum and instruction interventions, professional development, and technical assistance projects to produce a strong RtI model for District schools.
14. Assists the Executive Director, Student Services in carrying out the leadership role as related to RtI.
15. Envisions and articulates future program needs and identifies promising strategies and best practices for addressing those needs.
16. Acts on the basis of professional principles and generally accepted norms of professional behavior.
17. Works collaboratively with staff members and representatives from other agencies.

Marginal Duties and Responsibilities: Other duties as assigned.

Supervisory Responsibilities: None

Qualifications:

To perform this job successfully an individual must be able to perform each essential duty satisfactorily. The requirements listed below are representative of the knowledge, skill and/or ability required.

Education and/or Experience: Minimum of 5 years classroom teaching experience in general education. A minimum of 3 years of successful experience in coordinating a professional development or curriculum/school improvement project(s). Master's degree in education or a related field desired.

Interpersonal Skills: Works well with others. Maintains confidentiality; listens to others; keeps emotions under control. Remains open to others' ideas and contributes to building a positive team spirit; excellent problem solver.

E. CONSENT CALENDAR

3. **TITLE:** Amendment to District Master Contract for 2010/11 School Year for Nonsectarian, Nonpublic School (NPS) Services with Logan River Academy, Inc.

BACKGROUND: It is necessary to amend District Master Contract for NPS Services with Logan River Academy, Inc., per a change in placement services as mandated by Individualized Education Plan (IEP).

Services will be provided as designated in the student Individualized Education Plans (IEP's). The Master contract is effective from July 1, 2010, through June 30, 2011.

FINANCIAL IMPACT:

Not to exceed \$46,150.75.

This is an increase of \$760.13, and is within the adopted budget for services. No change to overall budget.

Funds to be paid from Nonsectarian, Nonpublic School Services account, #01.0-65000.0-57500-11802-5110-0000052.

ACTION RECOMMENDED: Ratify Amendment to District Master Contract for Nonsectarian, Nonpublic School Services (NPS) with Logan River Academy, Inc. Contract is necessary per a change in placement services as mandated by Individualized Education Plan (IEP). The Master Contract is effective from July 1, 2010, through June 30, 2011. Amount not to exceed \$46,150.75. This is an increase of \$760.13, and is within the adopted budget for services. No change to overall budget. Funds to be paid from Nonsectarian, Nonpublic School Services account, #01.0-65000.0-57500-11802-5110-0000052.

PREPARED BY: _____

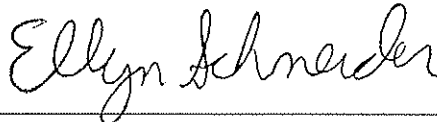

Ellyn Schneider, Executive Director of Student Services

DATE OF MEETING: November 17, 2011.

Approved by: _____

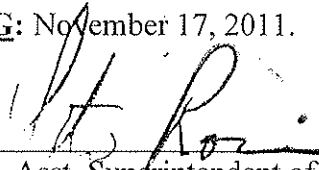

Steve Romines, Asst. Superintendent of Administrative Services

**AMENDMENT TO A GENERAL AGREEMENT FOR NONSECTARIAN,
NONPUBLIC SCHOOL / AGENCY SERVICES**

(Education Code Section 56365 et seq.)

THE GENERAL AGREEMENT FOR NONSECTARIAN, NONPUBLIC SCHOOL / AGENCY SERVICES, made and entered into on **September 15, 2010**, effective July 1, 2010 through June 30, 2011, between **Manhattan Beach Unified School District**, County of Los Angeles, hereinafter referred to as the "District" and **Logan River Academy, Inc.**, hereinafter referred to as the "Contractor," located at 1683 South Hwy 89/91, Logan, UT 84323, is hereby amended effective July 1, 2010, and ratified on , **November 17, 2010** as follows:

Payment under this contract may not exceed	<u>\$46,150.75</u>
Total LEA enrollment may not exceed	<u>3</u>

- CONTRACTOR -

- DISTRICT -

Logan River Academy, Inc.
Name of Non-Public School/Agency

Manhattan Beach Unified School District

By _____
Contracting Officer's Signature

by _____
Signature

Lori Connin, Finance Director

Ellyn Schneider,
Executive Director of Student Services

Date: _____

Date: _____

E. CONSENT CALENDAR

4. **TITLE:** Student Services Special Employment Agreement for 2010/11 School Year with Ro Seligson, M.A., OTR/L, ATP, Occupational Therapist.

BACKGROUND: An agreement is needed between the District and Ro Seligson, M.A., OTR/L, ATP, Occupational Therapist, to provide Occupational Therapy services, for the period November 1, 2010, through June 30, 2011.

FINANCIAL IMPACT:

Not to exceed \$6,200.00.

The amount is within the adopted budget for services.

No change to overall budget.

Funds to be paid from Special Education account,
#01.0-65000.0-57500-11905-5850-0000113.

ACTION RECOMMENDED: Ratify Student Services Special Employment Agreement for 2010/11 fiscal year with Ro Seligson, M.A., OTR/L, ATP, Occupational Therapist, to provide Occupational Therapy services, for the period November 1, 2010, through June 30, 2011. The amount is within the adopted budget for services. No change to overall budget. Amount not to exceed \$6,200.00. Funds to be paid from Special Education account, #01.0-65000.0-57500-11905-5850-0000113.

PREPARED BY:

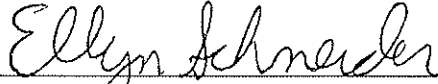

Ellyn Schneider, Executive Director of Student Services

DATE OF MEETING: November 17, 2010

Approved by:

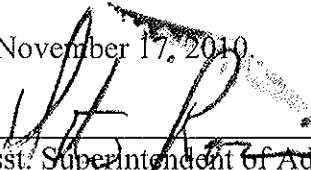

Steve Romines, Asst. Superintendent of Administrative Services

**MANHATTAN BEACH UNIFIED SCHOOL DISTRICT
SPECIAL EMPLOYMENT
AGREEMENT FOR SERVICES**

WHEREAS, It is the desire of the Governing Board of the Manhattan Beach Unified School District to employ or use the services of _____
Ro Seligson, Occupational Therapist

Soc Sec or Tax I.D. number _____ in the _____ Student Services _____ Department, and

WHEREAS, such service will assist the Governing Board in discharging its legal obligation to provide an adequate education program and will supplement assistance by the State and County authorities and not replace such assistance:

WITNESSETH:

THEREFORE, this agreement is made and entered into the 17th day of November, 2010, by and between the Manhattan Beach Unified School District and the above named person/agency, hereinafter called Consultant and located at: Rancho Palos Verdes, Ca 90275

SERVICES TO BE RENDERED

Said person/agency will serve/provide the following service(s): Occupational Therapy

This service does X does not _____ require direct contact with students.

PAYMENT TO BE MADE BY THE DISTRICT

In consideration of the service(s) to be rendered, the District agrees to pay \$100.00 per hour;
approx. 2 hrs/week. Total Not to Exceed \$6,200.00.

DATE(S) OF SERVICE

Said person/agency agrees to render service(s) on the following date(s) stated below:

From November 1, 2010, through June 30, 2011, under the direction of the Executive Director of Student Services.

The services will be provided in accordance to the District 2010 - 2011 academic calendar.

This agreement may be terminated by either party with twenty (20) days written notice. This agreement may be terminated without advance notice if both parties agree to do so in writing.

01.0-65000.0-57500-11905-5850-0000113

Account Number

Ro Seligson, OT
Provider of Service/Consultant

Occupational Therapy
Program

Ellyn Schneider,
Executive Director of Student Services

E. CONSENT CALENDAR

5. **TITLE:** Field Trip Request for Robinson Elementary School Fourth Grade Students to Visit Sacramento

BACKGROUND: Robinson Elementary School Principal Nancy Doyle is requesting permission to have the school's fourth grade students attend a day-long trip to Sacramento on June 17th, 2011. Approximately 62 students will travel by plane to the Sacramento area accompanied by two Robinson fourth grade teachers and adult chaperones. The gender-specific, Board-approved chaperone ratio will be observed. Along with our teachers as chaperones, the tour company provides additional supervision with docents. The program is funded through the parents; however, scholarships are available through Robinson PTSA funding.

The activities of the field trip are aligned with the California Social Studies Standards. By attending the trip to Sacramento, students will gain a wealth of knowledge regarding California's rich history and California's governmental structure as well as hands-on experiences that cannot be replicated in a classroom. Students will also develop an appreciation of our great state.

FISCAL IMPACT: None.

ACTION RECOMMENDED: Approval is recommended.

PREPARED BY: Carolyn Seaton, Executive Director, Educational Services

DATE OF BOARD MEETING: November 17, 2010

Manhattan Beach Unified School District

DAY FIELD TRIP REQUEST

(Requests must be processed 10 working days in advance)

Teacher Sponsor Kim Holtz Today's Date 10/27/10

Class or Group Grade 4 Robinson Date(s) of Field Trip 6/17/11

Destination Sacramento

Destination Address _____

Educational justification for day field trip Study of California
Social studies content standards application

Method of Transportation plane Number of Students 62

Names (first and last) of Chaperones List to be provided closer
to field trip

Cost to District \$0 Cost to Students \$360

Will a Substitute be needed? NO Which Periods? (Be Specific) N/A

Budget Charged (Subs) N/A

Have you checked the school calendar to see if there are important events your students will miss if they participate on this field trip? Yes No

Have you called in your request for a sub to the Sub Finder? N/A Yes No

Have you filled out a Request for a Sub form? N/A Yes No

Have your students completed Parent Permission Slips and returned them to you? Yes No

Administrator Signature [Signature] Date 10/27/10

Teacher Sponsor Signature [Signature] Date _____

- Field Trip Request must be processed at least 10 working days in advance.
- Each student must have a completed parent permission slip turned in to the teacher sponsor before going on the field trip.
- Return this form with all signatures to the principal. Keep a copy for your files.

16.

E. CONSENT ITEMS

13. **TITLE:** Gift Acceptance

BACKGROUND: In accordance with Board Policy #3290, it is the right of the Board to accept all gifts to the District, monetary and material.

We have received gifts from: Neil & Kate Malik, Sherry Hess & Liz Stromath.

ACTION RECOMMENDED: Accept with thanks, gifts from: Neil & Kate Malik, Sherry Hess & Liz Stromath.

PREPARED BY: Steve Romines

DATE OF BOARD MEETING: November 17, 2010

AGENDA NOTE AGENDA NOTE AGENDA NOTE

17.

Donor	Description	Site Donated To
Neil & Kate malik	Books	Pacific Elementary
Sherry Hess	Office Supplies	Pacific Elementary
Liz Stromath	Computer Monitor	Pacific Elementary

E. **CONSENT CALENDAR**

14. **TITLE:** Purchase Orders

BACKGROUND: The attached business item is standard. A listing of purchase orders to date is attached. Per Board directive, an explanation is included for each Purchase Order exceeding \$5,000.00.

ACTION RECOMMENDED: Ratify purchase orders to date.

PREPARED BY: Steve Romines

DATE OF MEETING: November 17, 2010

AGENDA NOTE AGENDA NOTE AGENDA NOTE

Manhattan Beach Unified School District - Business Services Division

Board List Purchase Orders Report

Purchase Orders/Buyouts To The Board for Ratification from: September 4th through November 5th 2010

Purchase Orders/Buyouts in Excess of \$100.00 To Be Ratified

District - 75333 Manhattan Beach USD

PO Issue Date	PO #	Change Order #	Vendor Name	Description	Department/Site	Fund	Res.Prj	Goal	Funct	OBJ	Sch/Loc	PO Amount
27-Jul-10	10818-5	1	27-Sep-10 US Bancorp	MAINTENANCE AGREEMENTS	Mira Costa,district-level	01.0	00000.0	11103	10000	4415	9000000	928.32 inc.
13-Sep-10	14425-3		13-Sep-10 Eagle Software	SOFTWARE, Attendance	Information Technology	01.0	11000.0	00000	24200	4340	0000116	6,050.00
14-Sep-10	14605-3		14-Sep-10 Witt Company	MAINTENANCE AGREEMENTS	Mira Costa,district-level	01.0	00000.0	11103	10000	5635	9000000	548.75
1-Jul-10	16642-2	1	26-Oct-10 Canon Business	PRINTING SUPP/EQUIP	Undistributed	01.0	00000.0	00000	72000	4950	0000000	2,000.00 inc.
2-Nov-10	18185-1		2-Nov-10 Biometrics4ALL, Inc.	MAINTENANCE AGREEMENTS	Human Resources	01.0	00000.0	00000	74001	5635	0000115	500.00
2-Nov-10	18185-1		2-Nov-10 Biometrics4ALL, Inc.	MAINTENANCE AGREEMENTS	Human Resources	01.0	00000.0	00000	74002	5635	0000115	500.00
7-Oct-10	18900-0		7-Oct-10 Energy Education	Previously board approved	Superintendent/Board	01.0	00000.0	00000	71100	5890	0000011	30,800.00
7-Sep-10	8420-7		7-Sep-10 U.S. Bank	FINANCIAL SERVICES	Undistributed	01.0	00000.0	00000	72000	5890	0000000	2,250.00
27-Oct-10	9372-6		27-Oct-10 Follett Software Co.	SOFTWARE	Grand View, PTA	01.0	90210.0	00000	24200	4340	1000400	730.51
27-Oct-10	9372-6		27-Oct-10 Follett Software Co.	SOFTWARE	Meadows, PTA	01.0	90220.0	00000	24200	4340	2000400	730.51
27-Oct-10	9372-6		27-Oct-10 Follett Software Co.	SOFTWARE	Pacific, PTA	01.0	90230.0	00000	24200	4340	3000400	730.51
27-Oct-10	9372-6		27-Oct-10 Follett Software Co.	SOFTWARE	Pennekamp, PTA	01.0	90240.0	00000	24200	4340	4000400	730.51
27-Oct-10	9372-6		27-Oct-10 Follett Software Co.	SOFTWARE	Robinson, PTA	01.0	90250.0	00000	24200	4340	5000400	730.51
27-Oct-10	9372-6		27-Oct-10 Follett Software Co.	SOFTWARE	MBMS, PTA	01.0	90280.0	00000	24200	4340	8000400	901.75
7-Jul-10	B11-006	2	3-Nov-10 Harley Ellis Devereaux	ARCHITECTURAL SERVICES	Auditorium Plans	01.0	90830.0	00000	85000	6210	9000400	125,500.00
29-Sep-10	S11-114		29-Sep-10 MacGill & Co	MEDICAL & LAB SUPP/EQUIP	Student Services	01.0	00000.0	00000	31400	4390	0000113	5,487.50
20-Sep-10	S11-190		20-Sep-10 LACOE	CONFERENCE AND TRAVEL	Educational Services	01.0	06405.0	00000	83000	5220	0000112	185.00
29-Sep-10	S11-197		29-Sep-10 Los Angeles County Office of Education	CONFERENCE AND TRAVEL	Student Services	01.0	00000.0	00000	31400	5220	0000113	100.00
7-Oct-10	S11-198		7-Oct-10 Coastal Training Technologies	FIRST AID SUPP/EQUIP	Student Services	01.0	00000.0	00000	31400	4390	0000113	588.60
5-Nov-10	S11-202		5-Nov-10 LACOE	Workshops	Title Two	01.0	40350.0	11100	10000	5220	0000112	200.00
19-Oct-10	S11-SBCH10		19-Oct-10 South Bay Children's Health Center	CONSULTANTS	Beach Cities Grant	01.0	90500.0	00000	31100	5850	0000113	95,368.00
15-Sep-10	T11-213		15-Sep-10 CDW-G	COMPUTER SUPP/EQUIP	Information Technology	01.0	11000.0	00000	24200	4310	0000116	797.05
15-Sep-10	T11-220		15-Sep-10 CDW-G	COMPUTER SUPP/EQUIP	Pennekamp, PTA	01.0	90240.0	00000	24200	4310	4000400	2,579.32
22-Sep-10	T11-221		7-Oct-10 PTM Document Systems	INSTRUCTIONAL SUPPLIES	Undistributed	25.0	00000.0	00000	72000	4400	0000000	3,901.49
7-Sep-10	T11-223		7-Sep-10 CDW-G	COMPUTER SUPP/EQUIP	Mira Costa,Donations	01.0	90290.0	00000	24200	4400	9000400	1,285.06
15-Sep-10	T11-224		15-Sep-10 CDW-G	MEDIA EQUIPMENT	Information Technology	01.0	11000.0	00000	24200	4310	0000116	866.88
13-Sep-10	T11-225		13-Sep-10 CDW-G	COMPUTER SUPP/EQUIP	MBMS, PTA	01.0	90280.0	00000	24200	4400	8000400	1,459.91
13-Sep-10	T11-226		13-Sep-10 Tiger Direct	COMPUTER SUPP/EQUIP	MBMS, PTA	01.0	90280.0	00000	24200	4400	8000400	287.36
13-Sep-10	T11-227		13-Sep-10 CDW-G	COMPUTER SUPP/EQUIP	Pennekamp, PTA	01.0	90240.0	00000	24200	4400	4000400	636.43
13-Sep-10	T11-228		13-Sep-10 CDW-G	COMPUTER SUPP/EQUIP	Undistributed	01.0	90300.0	11100	10000	4400	0000000	1,068.77
30-Sep-10	T11-229		30-Sep-10 CDW-G	COMPUTER SUPP/EQUIP	Information Technology	01.0	11000.0	00000	24200	4400	0000116	3,598.00
15-Sep-10	T11-230		15-Sep-10 CDW-G	COMPUTER SUPP/EQUIP	Mira Costa,Donations	01.0	90290.0	00000	24200	4400	9000400	2,179.87
16-Sep-10	T11-232		16-Sep-10 Fedtel	COMPUTER SUPP/EQUIP	MBMS, PTA	01.0	90280.0	00000	24200	4400	8000400	736.83
16-Sep-10	T11-233		16-Sep-10 Fedtel	MEDIA EQUIPMENT	MBMS, PTA	01.0	90280.0	00000	24200	4400	8000400	1,952.63
23-Sep-10	T11-234		23-Sep-10 LearnMedia Consulting	CONTRACTED SERVICES	Information Technology	01.0	11000.0	00000	00000	4340	0000116	1,750.00
30-Sep-10	T11-235		30-Sep-10 Dell	OFFICE MACHINES SUPP/SERVICES	MC, report card printer	01.0	00000.0	00000	00000	9320	0000000	6,986.52
30-Sep-10	T11-236		30-Sep-10 LearnMedia Consulting	CONTRACTED SERVICES	Information Technology	01.0	11000.0	00000	24200	4340	0000116	600.00
5-Oct-10	T11-237		5-Oct-10 NEC Unified Solutions, Inc	TELEPHONE SUPP/EQUIP/SYSTEM	Pennekamp,Donations	01.0	90440.0	00000	27000	4350	4000400	407.50
8-Oct-10	T11-239		8-Oct-10 CDW-G	OFFICE MACHINES SUPP/SERVICES	Undistributed	01.0	00000.0	00000	00000	9320	0000000	589.36
8-Oct-10	T11-240		8-Oct-10 Package Products and Services	SOFTWARE	Business Office	01.0	00000.0	00000	73000	5890	0000114	4,649.64
8-Oct-10	T11-241		8-Oct-10 Bi Pro Computers	INSTRUCTIONAL SUPPLIES	Futures Institute	01.0	90403.0	13402	10000	4310	8000400	122.84
18-Oct-10	T11-242		18-Oct-10 Charter School Management Corporation	CONTRACTED SERVICES	Information Technology	01.0	11000.0	00000	24200	4340	0000116	1,250.00
21-Oct-10	T11-244		21-Oct-10 CDW-G	MEDIA EQUIPMENT	MBMS, PTA	01.0	90280.0	00000	24200	4400	8000400	2,179.87
25-Oct-10	T11-245		25-Oct-10 CDW-G	COMPUTER SUPP/EQUIP	Information Technology	01.0	11000.0	00000	24200	5635	0000116	1,064.58
28-Oct-10	T11-246		28-Oct-10 CDW-G	COMPUTER SUPP/EQUIP	Mira Costa, PTA	01.0	90290.0	00000	24200	4310	9000400	10,116.01
28-Oct-10	T11-247		28-Oct-10 Phone Supplement	BATTERIES	Information Technology	01.0	11000.0	00000	24200	4310	0000116	181.09
28-Oct-10	T11-248		28-Oct-10 Fedtel	TELEPHONE SUPP/EQUIP/SYSTEM	Information Technology	01.0	11000.0	00000	24200	4310	0000116	132.67
2-Nov-10	T11-249		2-Nov-10 Dell	OFFICE MACHINES SUPP/SERVICES	MBMS, PTA	01.0	90280.0	00000	24200	4400	8000400	576.17

20.

Manhattan Beach Unified School District - Business Services Division

PO Issue Date	Change Order #	PO #	Date	Vendor Name	Description	Department/Site	Fund	Res.Prj	Goal	Funct	OBJ	Sch/Loc	PO Amount
50		2-Nov-10	2-Nov-10	Fedtel	TELEPHONE SUPP/EQUIP/SYSTEM	Information Technology	01.0	11000.0	00000	24200	4310	0000116	532.05
51		28-Sep-10	28-Sep-10	Office Depot	OFFICE SUPPLIES	Pacific, PTA	01.0	90230.0	18601	10000	4310	3000400	377,988.37
52		14-Sep-10	14-Sep-10	3 S Corp	PAPER PRODUCTS AND PAPERBOARD	Paper Products and Paperboard	01.0	90240.0	11101	10000	4310	1000400	12,487.50
53		7-Oct-10	7-Oct-10	3 S Corp	PAPER PRODUCTS AND PAPERBOARD	Paper Products and Paperboard	01.0	90220.0	11101	10000	4310	2000400	10,000.00
54		19-Oct-10	19-Oct-10	Think4inc.com	OFFICE SUPPLIES	Pennekamp, PTA	01.0	90240.0	11101	10000	4310	4000400	7,500.00
55		19-Oct-10	19-Oct-10	School Specialty Company	INSTRUCTIONAL SUPPLIES	Pennekamp, Donations	01.0	90440.0	11101	10000	4310	4000400	2,823.13
56		14-Sep-10	14-Sep-10	California Steeplejack & Painting Compan	CONTRACTED SERVICES	Maintenance Yard	01.0	81500.0	00000	81100	5630	0000117	556.75
57		20-Sep-10	20-Sep-10	Tri-Signal Integration	FIRE SAFETY SUPP/EQUIP/SYSTEM	Maintenance Yard	01.0	81500.0	00000	81100	5630	0000117	219.50
58		14-Sep-10	14-Sep-10	Chemsearch	MAINTENANCE SUPP/EQUIP	Maintenance Yard	01.0	81500.0	00000	81100	4380	0000117	33,588.88
59		27-Sep-10	27-Sep-10	Office Depot	OFFICE SUPPLIES	Maintenance Yard	01.0	81500.0	00000	81100	4380	0000117	2,197.70
60		14-Sep-10	14-Sep-10	ACCO Engineered Systems	AIR CONDITIONING SERVICE/SYST	Maintenance Yard	01.0	81500.0	00000	81100	4380	0000117	17,502.93
61		14-Sep-10	14-Sep-10	California Fence Company	FENCING	Maintenance Yard	01.0	81500.0	00000	81100	4380	0000117	343.52
62		14-Sep-10	14-Sep-10	Gardena Welding Supply Co., Inc.	MAINTENANCE SUPP/EQUIP	Maintenance Yard	01.0	81500.0	00000	81100	4380	0000117	2,146.25
63		1-Nov-10	1-Nov-10	Hertz Equipment Rental	EQUIPMENT RENTAL/LEASE	Maintenance Yard	01.0	81500.0	00000	81100	5630	0000117	4,390.00
64		8-Oct-10	8-Oct-10	Lou's Golf and Industrial Carts	AUTOMOTIVE SUPP/EQUIP	Maintenance Yard	01.0	00000.0	00000	81100	4380	0000117	2,195.00
65		8-Oct-10	8-Oct-10	Metro Chem Industries	JANITORIAL SUPP/EQUIP	Maintenance Yard	01.0	00000.0	00000	82000	4370	0000117	20,000.00
66		14-Sep-10	14-Sep-10	Smarthen Supply	JANITORIAL SUPP/EQUIP	Maintenance Yard	01.0	00000.0	00000	82000	4370	0000117	3,100.00
67		14-Sep-10	14-Sep-10	Turf Star, Inc.	LANDSCAPE/GARDENING SUPP/EQUIP	Maintenance Yard	01.0	00000.0	00000	82050	4370	0000117	500.00
68		8-Oct-10	8-Oct-10	Winzer Corporation	JANITORIAL SUPP/EQUIP	Maintenance Yard	01.0	00000.0	00000	82000	4370	0000117	1,097.50
69		2-Nov-10	2-Nov-10	McKinney, J. M. Company	PLUMBING SUPP/SYSTEM	Maintenance Yard	01.0	81500.0	00000	81100	4380	0000117	1,097.50
70		8-Oct-10	8-Oct-10	Norwalk Power Equipment Company	MAINTENANCE SUPP/EQUIP	Maintenance Yard	01.0	81500.0	00000	81100	4380	0000117	1,097.50
71		14-Sep-10	14-Sep-10	PEP System Testing	MAINTENANCE AGREEMENTS	Maintenance Yard	01.0	81500.0	00000	81100	5630	0000117	1,097.50
72		8-Oct-10	8-Oct-10	Shiffler Equipment Sales	HARDWARE SUPPLIES	Maintenance Yard	01.0	81500.0	00000	81100	4380	0000117	4,200.00
73		14-Sep-10	14-Sep-10	Seers Lumber	LUMBER	Maintenance Yard	01.0	81500.0	00000	81100	4380	0000117	1,646.25
74		18-Aug-10	18-Aug-10	Tri-Signal Integration	FIRE SAFETY SUPP/EQUIP/SYSTEM	Maintenance Yard	01.0	81500.0	00000	81100	4380	0000117	2,000.00
75		14-Sep-10	14-Sep-10	Water, Inc.	PLUMBING SUPP/SYSTEM	Maintenance Yard	01.0	81500.0	00000	81100	5630	0000117	526.80
76		14-Sep-10	14-Sep-10	Westwood Building Materials	LUMBER	Maintenance Yard	01.0	81500.0	00000	81100	4380	0000117	5,000.00
77		2-Nov-10	2-Nov-10	Lucky's Glass, LLC	GLASS AND GLASS PRODUCTS	Maintenance Yard	01.0	81500.0	00000	81100	4380	0000117	1,097.50
78		20-Sep-10	20-Sep-10	YESCO	LIGHTING SUPP/EQUIP/MAINT/SYST	Maintenance Yard	01.0	00000.0	00000	81100	5630	0000117	50,638.45
79		7-Sep-10	7-Sep-10	Brown Industries	AWARDS/CERTIFICATES	Human Resources	01.0	00000.0	00000	74001	4350	0000115	1,695.14
80		7-Sep-10	7-Sep-10	Brown Industries	AWARDS/CERTIFICATES	Human Resources	01.0	00000.0	00000	74002	4350	0000115	392.45
81		14-Sep-10	14-Sep-10	Tennant Company	MAINTENANCE SUPP/EQUIP	Maintenance Yard	01.0	00000.0	00000	82000	4370	0000117	296.05
82		7-Sep-10	7-Sep-10	McGraw-Hill	INSTRUCTIONAL SUPPLIES	District-level,K-5	01.0	07156.0	11101	10000	4110	0000051	1,025.72
83		7-Sep-10	7-Sep-10	Science Olympiad	INSTRUCTIONAL SUPPLIES	Futures Institute	01.0	90403.0	13402	10000	4310	8000400	2,201.05
84		7-Sep-10	7-Sep-10	Vex	Science Lab Kit	Futures Institute	01.0	90403.0	13402	10000	4310	8000400	195.50
85		7-Sep-10	7-Sep-10	Follett Ed Services	Foreign Language Books	District-level,K-5	01.0	07156.0	11101	10000	4310	8000051	6,083.63
86		7-Sep-10	7-Sep-10	Perma-Bound Books	INSTRUCTIONAL SUPPLIES	District-level,K-5	01.0	07156.0	11101	10000	4310	8000051	3,316.04
87		7-Sep-10	7-Sep-10	First Student	BUSES	District-level,K-5	01.0	07156.0	11101	10000	4210	0000051	439.82
88		7-Sep-10	7-Sep-10	First Student	BUSES	MBMS Vocal Music	01.0	98172.0	17202	10000	5812	8000400	756.26
89		7-Sep-10	7-Sep-10	First Student	BUSES	MBMS Vocal Music	01.0	98172.0	17202	10000	5812	8000400	1,277.56
90		7-Sep-10	7-Sep-10	McGraw-Hill	INSTRUCTIONAL SUPPLIES	MBMS Vocal Music	01.0	98172.0	17202	10000	5812	8000400	1,016.92
91		7-Sep-10	7-Sep-10	Easy Grammar Systems	BOOKS	District-level,K-5	01.0	07156.0	11101	10000	4110	0000051	1,105.60
92		14-Sep-10	14-Sep-10	Xerox - The Document Company	OFFICE MACHINES SUPP/SERVICES	District-level,K-5	01.0	90290.0	11103	10000	4310	9000400	37.95
93		7-Sep-10	7-Sep-10	CDE Press	INSTRUCTIONAL SUPPLIES	Mira Costa, PTA	01.0	40350.0	11100	10000	4310	9000400	819.06
94		7-Sep-10	7-Sep-10	Morey's Music Store, Inc.	MUSICAL INSTRUMENTS/SUPP	Title Two	01.0	90401.0	17201	10000	4310	0000112	141.38
95		7-Sep-10	7-Sep-10	Southwest Strings	MUSICAL INSTRUMENTS/SUPP	Music Donations	01.0	90401.0	17201	10000	4310	0000112	500.00
96		7-Sep-10	7-Sep-10	Follett Ed Services	INSTRUCTIONAL SUPPLIES	Music Donations	01.0	07156.0	11101	10000	4310	0000112	1,000.00
97		7-Sep-10	7-Sep-10	Follett Ed Services	INSTRUCTIONAL SUPPLIES	District-level,K-5	01.0	07156.0	11101	10000	4110	0000051	398.19

Manhattan Beach Unified School District - Business Services Division

PO Issue	Date	PO #	Change Order	# PO	Vendor Name	Description	Department/Site	Fund	Res.Prj	Goal	Funct	Obj	Sch/Loc	PO Amount
103	7-Sep-10	18806	7-Sep-10 Follett Ed Services		INSTRUCTIONAL SUPPLIES	District-level,K-5	01.0	07156.0	11101	10000	4110	0000051	4,257.93	
104	13-Sep-10	18810	13-Sep-10 LACOE		CONFERENCE AND TRAVEL	English Learners	01.0	62860.0	47600	10000	5220	0000112	140.00	
105	13-Sep-10	18812	13-Sep-10 Saxon Publishers, Inc.		INSTRUCTIONAL SUPPLIES	District-level,K-5	01.0	07156.0	11101	10000	4110	0000051	981.80	
106	13-Sep-10	18814	13-Sep-10 Prentice Hall School Division		BOOKS	IMFRP, 9-12	01.0	07156.0	11103	10000	4110	0000053	3,797.70	
107	13-Sep-10	18815	13-Sep-10 UC Irvine		CONFERENCE AND TRAVEL	Title Two	01.0	40350.0	11100	10000	4310	0000112	150.00	
108	13-Sep-10	18816	13-Sep-10 Career Track		CONFERENCE AND TRAVEL	Human Resources	01.0	00000.0	00000	74001	5220	0000115	114.50	
109	13-Sep-10	18816	13-Sep-10 Career Track		CONFERENCE AND TRAVEL	Human Resources	01.0	00000.0	00000	74002	5220	0000115	114.50	
110	14-Sep-10	18824	14-Sep-10 Trugreen Landscape		LANDSCAPE CONTRACTORS	Maintenance Yard	01.0	00000.0	00000	82050	5630	0000117	1,533.00	
111	20-Sep-10	18833	20-Sep-10 CASBO		CONFERENCE AND TRAVEL	Business Office	01.0	00000.0	00000	73000	5220	0000114	475.00	
112	20-Sep-10	18847	20-Sep-10 Scantron		FORMS	Warehouse stores	01.0	00000.0	00000	00000	9320	0000000	6,269.66	
113	20-Sep-10	18852	20-Sep-10 Manhattan Beach Coordinating Council		INSTRUCTIONAL SUPPLIES	Superintendent/Board	01.0	00000.0	00000	71500	5310	0000011	210.00	
114	22-Sep-10	18856	22-Sep-10 Musician's Friend		MUSICAL INSTRUMENTS/SUPP	Mira Costa,discretionary	01.0	00000.0	17243	10000	4310	9000100	436.81	
115	20-Sep-10	18857	20-Sep-10 LACOE		Membership in EASE	Human Resources	01.0	00000.0	00000	74002	5310	0000115	6,548.40	
116	27-Sep-10	18862	27-Sep-10 E & H Trophy		SIGNS	Superintendent/Board	01.0	00000.0	00000	71100	4400	0000011	199.20	
117	27-Sep-10	18867	27-Sep-10 Good-Lite Co.		LIGHTING SUPP/EQUIP/MAINT/SYST	Student Services	01.0	00000.0	00000	31400	4390	0000113	130.85	
118	27-Sep-10	18873	27-Sep-10 ASCIP		LEGAL SERVICES	Human Resources	01.0	00000.0	00000	74002	5820	0000115	24,000.00	
119	1-Oct-10	18881	1-Oct-10 Motel Six		HOTELS	Human Resources	01.0	00000.0	00000	74001	5220	0000115	209.40	
120	5-Oct-10	18885	5-Oct-10 Copy Shop, The		PRINTING SERVICES	Superintendent/Board	01.0	00000.0	00000	71500	4350	0000011	420.34	
121	19-Oct-10	18889	19-Oct-10 Global Transportation Services		BUSES	Mira Costa,discretionary	01.0	00000.0	12003	10000	5812	9000100	700.00	
122	6-Oct-10	18890	6-Oct-10 School Services of California Inc.		CONFERENCE AND TRAVEL	Business Office	01.0	00000.0	00000	73000	5220	0000114	190.00	
123	25-Oct-10	18909	25-Oct-10 State Electric		CONTRACTORS, GENERAL/SPECIFIC	Maintenance Yard	01.0	00000.0	00000	82050	5630	0000117	1,561.00	
124	25-Oct-10	18910	25-Oct-10 State Electric		CONTRACTORS, GENERAL/SPECIFIC	Maintenance Yard	01.0	00000.0	00000	82050	5630	0000117	1,465.00	
125	18-Oct-10	18911	18-Oct-10 Dick Blick		INSTRUCTIONAL SUPPLIES	Mira Costa,discretionary	01.0	00000.0	17103	10000	4310	9000100	1,967.97	
126	19-Oct-10	18917	19-Oct-10 Haan Crafts Corp		INSTRUCTIONAL SUPPLIES	Mira Costa,discretionary	01.0	00000.0	17123	10000	4310	9000100	946.63	
127	19-Oct-10	18920	19-Oct-10 Luella's Quilt Shop		SEWING MACHINES	Mira Costa,discretionary	01.0	00000.0	18303	10000	4310	9000100	1,013.07	
128	19-Oct-10	18921	19-Oct-10 Enviroscope		INSTRUCTIONAL SUPPLIES	Mira Costa,discretionary	01.0	00000.0	18303	10000	4310	9000100	138.11	
129	21-Oct-10	18931	21-Oct-10 Creattech Services		LANDSCAPE CONTRACTORS	Maintenance Yard	01.0	00000.0	00000	82050	5630	0000117	1,800.00	
130	29-Oct-10	18941	29-Oct-10 Creative Competitions Inc.		CONTRACTED SERVICES	Business Office	01.0	00000.0	00000	82070	5630	0000114	110.00	
131	2-Nov-10	18943	2-Nov-10 Vista Higher Learning		FEES, LICENSE	GATE	01.0	07140.0	19000	10000	5310	0000112	705.00	
132	27-Sep-10	18842	27-Sep-10 Glencoe/McGraw Hill		BOOKS	IMFRP, 9-12	01.0	07156.0	12003	10000	4110	0000053	2,765.70	
133	27-Sep-10	18843	27-Sep-10 Glencoe/McGraw Hill		INSTRUCTIONAL SUPPLIES	IMFRP, K-5	01.0	07156.0	11101	10000	4110	0000051	778.17	
134	1-Oct-10	18870	1-Oct-10 Follett Ed Services		INSTRUCTIONAL SUPPLIES	IMFRP, K-5	01.0	07156.0	11101	10000	4110	0000051	1,751.66	
135	1-Oct-10	18876	1-Oct-10 Follett Ed Services		INSTRUCTIONAL SUPPLIES	IMFRP, K-5	01.0	07156.0	11101	10000	4110	0000051	265.44	
136	1-Oct-10	18877	1-Oct-10 Houghton Mifflin Co.		INSTRUCTIONAL SUPPLIES	IMFRP, K-5	01.0	07156.0	11101	10000	4110	0000051	285.44	
137	8-Oct-10	18893	8-Oct-10 Follett Ed Services		INSTRUCTIONAL SUPPLIES	IMFRP, 6-8	01.0	07156.0	11102	10000	4110	0000052	145.31	
138	19-Oct-10	18898	19-Oct-10 Macmillan/McGraw-Hill		BOOKS	IMFRP, K-5	01.0	07156.0	11101	10000	4110	0000051	850.25	
139	19-Oct-10	18899	19-Oct-10 Macmillan/McGraw-Hill		BOOKS	IMFRP, K-5	01.0	07156.0	11101	10000	4110	0000051	584.90	
140	15-Oct-10	18905	15-Oct-10 Textbook Warehouse Inc.		BOOKS	IMFRP, 9-12	01.0	07156.0	11103	10000	4110	0000053	240.98	
141	27-Oct-10	18938	27-Oct-10 IXL		SOFTWARE, Math	IMFRP, K-5	01.0	07156.0	11101	10000	4340	0000051	6,800.00	
142	23-Sep-10	18861	23-Sep-10 Illuminate Education		SOFTWARE	Information Technology	01.0	11000.0	00000	24200	4340	0000116	25,948.00	
143	5-Oct-10	18884	5-Oct-10 Manhattan Beach Unified School District		SCHOOLS	Title One, homeless	01.0	30100.0	11100	10000	5890	0000112	495.00	
144	7-Oct-10	18892	7-Oct-10 Manhattan Beach Unified School District		SCHOOLS	Title One, homeless	01.0	30100.0	11100	10000	5890	0000112	7,200.00	
145	5-Nov-10	18954	5-Nov-10 San Bernardino County		Workshops	SDFS	01.0	37100.0	11100	10000	5220	0000112	1,500.00	
146	5-Nov-10	18958	5-Nov-10 Ideas Unlimited Seminars, Inc		Workshops	SDFS	01.0	37100.0	11100	10000	5220	0000112	199.00	
147	1-Oct-10	18875	1-Oct-10 LACOE		CONFERENCE AND TRAVEL	Title Two	01.0	40350.0	11100	10000	5220	0000112	110.00	
148	21-Oct-10	18925	21-Oct-10 Houghton Mifflin Co.		CONFERENCE AND TRAVEL	Title Two	01.0	40350.0	11100	10000	5220	0000112	2,000.00	
149	25-Oct-10	18908	25-Oct-10 State Electric		CONTRACTORS, GENERAL/SPECIFIC	Grand View PA Center	01.0	81500.0	00000	81100	5630	0000117	7,470.00	
150	25-Oct-10	18916	25-Oct-10 Chemsearch		MAINTENANCE SUPP/EQUIP	Maintenance Yard	01.0	81500.0	00000	81100	4400	0000117	1,650.00	
151	19-Oct-10	18924	19-Oct-10 Vision Communications Co.		RADIOS	Maintenance Yard	01.0	81500.0	00000	81100	4380	0000117	11,485.34	
152	2-Nov-10	18940	2-Nov-10 Telenet VoIP, Inc.		SECURITY SUPP/EQUIP/SYSTEM	Maintenance Yard	01.0	81500.0	00000	81100	4380	0000117	1,618.81	
153	2-Nov-10	18940	2-Nov-10 Telenet VoIP, Inc.		SECURITY SUPP/EQUIP/SYSTEM	Maintenance Yard	01.0	81500.0	00000	81100	4380	0000117	1,200.00	
154	16-Sep-10	18834	16-Sep-10 Canon Business		OFFICE MACHINES SUPP/SERVICES	Grand View, PTA	01.0	90210.0	11101	10000	4310	1000400	915.00	

22

Manhattan Beach Unified School District - Business Services Division

PO Issue Date	PO #	Change Order #	Date	Vendor Name	Description	Department/Site	Fund	Res.Prj	Goal	Funct	OBJ	Sch/Loc	PO Amount
155	16-Sep-10 18835		16-Sep-10	Scantron	TEST/TEST MATERIALS	Grand View, PTA	01.0	90210.0	11101	10000	4310	1000400	385.57
156	27-Sep-10 18865		27-Sep-10	Sportime	PHYSICAL EDUCATION SUPP/EQUIP	Grand View, PTA	01.0	90210.0	11101	10000	4310	1000400	289.27
157	21-Oct-10 18930		21-Oct-10	Riso	OFFICE MACHINES SUPP/SERVICES	Grand View, PTA	01.0	90210.0	11101	10000	4310	1000400	530.10
158	2-Nov-10 18950		2-Nov-10	Deborah Delamarier	Afterschool Enrichment	Grand View, PTA	01.0	90215.0	11101	10000	5890	1000400	765.00
159	5-Nov-10 18955		5-Nov-10	Deborah Delamarier	Afterschool Enrichment	Grand View, PTA	01.0	90215.0	11101	10000	5890	1000400	990.00
160	21-Oct-10 18933		21-Oct-10	Deborah Delamarier	Afterschool Enrichment	Meadows, PTA	01.0	90225.0	11101	10000	5890	2000400	540.00
161	5-Nov-10 18956		5-Nov-10	Deborah Delamarier	Afterschool Enrichment	Meadows, PTA	01.0	90225.0	11101	10000	5890	2000400	607.50
162	20-Sep-10 18844		20-Sep-10	Pacific Coachways	BUSES	Pacific, PTA	01.0	90230.0	11101	10000	5812	3000400	816.00
163	1-Oct-10 18854		1-Oct-10	Xerox - The Document Company	OFFICE MACHINES SUPP/SERVICES	Pacific, PTA	01.0	90230.0	11101	10000	5812	3000400	200.00
164	5-Oct-10 18869		5-Oct-10	Brain Pop	SOFTWARE	Pacific, PTA	01.0	90230.0	00000	24200	4340	3000400	895.00
165	5-Oct-10 18882		5-Oct-10	Pacific Coachways	BUSES	Pacific, PTA	01.0	90230.0	11101	10000	5812	3000400	864.00
166	19-Oct-10 18926		19-Oct-10	Deborah Delamarier	Afterschool Enrichment	Pennekamp, PTA	01.0	90245.0	11101	10000	5890	4000400	360.00
167	29-Oct-10 18942		29-Oct-10	Dulce Capadocia	Afterschool Enrichment	Pennekamp, PTA	01.0	90245.0	11101	10000	5890	4000400	360.00
168	20-Sep-10 18845		20-Sep-10	Mary Lynn McIver	Afterschool Enrichment	Robinson, PTA	01.0	90255.0	11101	10000	5890	5000400	9,800.00
169	20-Sep-10 18846		20-Sep-10	Jon Fowler	Afterschool Enrichment	Robinson, PTA	01.0	90255.0	11101	10000	5890	5000400	3,500.00
170	5-Nov-10 18957		5-Nov-10	Mary Lynn McIver	Afterschool Enrichment	Robinson, PTA	01.0	90255.0	11101	10000	5890	5000400	660.00
171	27-Sep-10 18868		27-Sep-10	Brain Pop	SUBSCRIPTIONS	Robinson, PTA	01.0	90260.0	11102	10000	4340	8000400	995.00
172	8-Oct-10 18894		8-Oct-10	World Book School & Library	SUBSCRIPTIONS	MBMS, PTA	01.0	90280.0	00000	24200	4340	8000400	1,531.01
173	2-Nov-10 18948		2-Nov-10	123 Inkjets	OFFICE MACHINES SUPP/SERVICES	MBMS, PTA	01.0	90290.0	00000	24200	4310	9000400	107.53
174	8-Oct-10 18895		8-Oct-10	Dietz Bros. Music	MUSICAL INSTRUMENTS/SUPP	Mira Costa, Donations	01.0	90401.0	17201	10000	5630	0000112	109.75
175	25-Oct-10 18937		25-Oct-10	Music in the Parks	Performance Fee	Music Donations	01.0	90401.0	17201	10000	4310	0000112	6,200.00
176	2-Nov-10 18952		2-Nov-10	City of Manhattan Beach - Police Dept	FEES, LICENSE	Music Donations	01.0	90401.0	17201	10000	5890	0000112	280.00
177	2-Nov-10 18953		2-Nov-10	Pacific Coachways Charter Services	BUSES	Music Donations	01.0	90401.0	17201	10000	5812	0000112	3,500.00
178	1-Oct-10 18871		1-Oct-10	Global Transportation Services	BUSES	GATE field trips	01.0	90402.0	11102	10000	5812	8000400	800.00
179	1-Oct-10 18872		1-Oct-10	Global Transportation Services	BUSES	GATE field trips	01.0	90402.0	11102	10000	5812	8000400	800.00
180	18-Oct-10 18915		18-Oct-10	Ocean Institute	FIELD TRIPS	GATE field trips	01.0	90402.0	11102	10000	5890	8000400	5,400.00
181	22-Oct-10 18934		22-Oct-10	Sion's Restaurant	CATERING SERVICES	Student Services	01.0	90405.0	00000	31400	4310	0000113	132.15
182	21-Oct-10 18929		21-Oct-10	California Western Visuals	Smart Board	Futures Institute	01.0	90407.0	13400	10000	4000	0000112	7,851.06
183	16-Sep-10 18836		16-Sep-10	First Student	BUSES	Pennekamp, Donations	01.0	90440.0	11101	10000	5812	4000400	756.26
184	16-Sep-10 18837		16-Sep-10	First Student	BUSES	Pennekamp, Donations	01.0	90440.0	11101	10000	5812	4000400	508.45
185	16-Sep-10 18838		16-Sep-10	First Student	BUSES	Pennekamp, Donations	01.0	90440.0	11101	10000	5812	4000400	886.58
186	27-Sep-10 18863		27-Sep-10	First Student	BUSES	Pennekamp, Donations	01.0	90440.0	11101	10000	5812	4000400	886.58
187	18-Oct-10 18914		18-Oct-10	First Student	BUSES	Pennekamp, Donations	01.0	90440.0	11101	10000	5812	4000400	886.58
188	21-Oct-10 18932		21-Oct-10	First Student	BUSES	ASAP, MBMS	01.0	90700.0	11102	10000	5812	8000400	5,300.00
189	20-Sep-10 18849		20-Sep-10	Formal Fashions	INSTRUCTIONAL SUPPLIES	MBMS Vocal Music	01.0	98172.0	17202	10000	4310	8000400	1,138.54
190	27-Sep-10 18864		27-Sep-10	Formal Fashions	UNIFORMS	MBMS Vocal Music	01.0	98172.0	17202	10000	4310	8000400	2,903.04
191	19-Oct-10 18922		19-Oct-10	R.P. & Associates	INSTRUCTIONAL SUPPLIES	MBMS Vocal Music	01.0	98172.0	17202	10000	4310	8000400	978.92
192	25-Oct-10 18935		25-Oct-10	Q Danylik	INSTRUCTIONAL SUPPLIES	MBMS Vocal Music	01.0	98172.0	17202	10000	4310	8000400	283.32
193	16-Sep-10 18828		16-Sep-10	Morey's Music Store, Inc.	MUSICAL INSTRUMENTS/SUPP	MBMS Instrumental Music	01.0	98175.0	17252	10000	5630	8000400	1,099.90
194	5-Oct-10 18886		5-Oct-10	Morey's Music Store, Inc.	MUSICAL INSTRUMENTS/SUPP	MBMS Instrumental Music	01.0	98175.0	17252	10000	4310	8000400	1,374.40
195	19-Oct-10 18918		19-Oct-10	Q Danylik	UNIFORMS	MBMS Instrumental Music	01.0	98175.0	17252	10000	4310	8000400	5,130.37
196													241,104.32
197													743,320.02
198	Special Education												
199	12-Oct-10 S11-105		12-Oct-10	WPS	TEST/TEST MATERIALS	Student Services	01.0	33130.0	57700	31200	4310	0000113	5,297.14
200	7-Sep-10 S11-189		7-Sep-10	American Cap and Gown	INSTRUCTIONAL SUPPLIES	Student Services	01.0	65000.0	50010	31100	4310	0000113	101.95
201	20-Sep-10 S11-191		20-Sep-10	LRP	INSTRUCTIONAL SUPPLIES	Student Services	01.0	33130.0	57500	11300	4310	0000113	222.42
202	20-Sep-10 S11-193		20-Sep-10	AnsMar Publishers, Inc.	INSTRUCTIONAL SUPPLIES	Student Services	01.0	33130.0	57500	11300	4310	0000113	110.17
203	17-Sep-10 S11-194	1	20-Sep-10	WPS	CONFERENCE AND TRAVEL	Student Services	01.0	33130.0	50010	31100	5220	0000113	361.08
204	29-Sep-10 S11-195		29-Sep-10	Cambium Learning Voyager	INSTRUCTIONAL SUPPLIES	Student Services	01.0	33130.0	57500	11300	4310	0000113	568.40
205	27-Sep-10 S11-196		27-Sep-10	Harcourt Assent	TEST/TEST MATERIALS	Student Services	01.0	33130.0	57700	31200	4310	0000113	2,467.13
206	25-Oct-10 S11-199		25-Oct-10	ATG Rehab	INSTRUCTIONAL SUPPLIES	Student Services	01.0	65000.0	57500	11300	4400	0000113	898.99

Manhattan Beach Unified School District - Business Services Division

PO Issue	Change Order #	Date	Vendor Name	Description	Department/Site	Fund	Res.Prj	Goal	Funct	OBJ	Sch/Loc	PO Amount	
207		20-Oct-10	Harcourt Assmt	TEST/TEST MATERIALS	Student Services	01.0	33130.0	57700	31200	4310	0000113	161.46	
208		2-Nov-10	PCI Educational Publishing	INSTRUCTIONAL SUPPLIES	Student Services	01.0	33130.0	57500	11300	4310	0000113	277.54	
209		Individual Service Agreements (purchase orders to cover board approved contracts)											
210		19-Oct-10	Dr. Albert K. Chun, O.D., F.C.O.V.D.	MEDICAL/HEALTH CARE PAYMENTS	Student Services	01.0	65000.0	50010	31400	5850	0000113	300.00	
211		27-Sep-10	Heather Clare	Occupational Therapy	Student Services	01.0	65000.0	57500	11905	5890	0000113	4,655.00	
212		27-Sep-10	Heather Clare	Occupational Therapy	Student Services	01.0	65000.0	57500	11905	5850	0000113	24,885.00	
213		19-Oct-10	Green Door Learning, LLC	CONSULTANTS	Student Services	01.0	65000.0	57500	11300	5850	0000113	3,150.00	
214		19-Oct-10	Susan H. Norwell M.A.	CONSULTANTS	Student Services	01.0	65000.0	57500	11300	5850	0000113	7,200.00	
215		19-Oct-10	UCLA Behavior Health Services	CONSULTANTS	Student Services	01.0	65000.0	57500	31200	5850	0000113	400.00	
216		12-Oct-10	LACOE	Excess Costs	Student Services	01.0	65000.0	57500	92000	7142	0000113	1,428,684.00	
217		12-Oct-10	Administrative Service Co-Op	TRANSPORTATION SUPP/EQUIP/SERV	Student Services	01.0	65000.0	57500	36000	5112	0000113	215,000.00	
218		12-Oct-10	Administrative Service Co-Op	TRANSPORTATION SUPP/EQUIP/SERV	District-level, Post-High Sch.	01.0	65000.0	57504	36000	5812	0000054	30,000.00	
219		19-Oct-10	Durham Transportation	TRANSPORTATION SUPP/EQUIP/SERV	Undistributed	01.0	65000.0	57500	36000	5812	0000000	285,000.00	
220		19-Oct-10	Pawar Transportation	TRANSPORTATION SUPP/EQUIP/SERV	Undistributed	01.0	65000.0	57500	36000	5812	0000000	70,000.00	
221		17-Sep-10	Beach Citites Learning Center	Non Public Agency Services	District-level,9-12	01.0	65000.0	57500	11802	5110	0000053	30,780.00	
222		17-Sep-10	Beach Citites Learning Center	Non Public Agency Services	District-level,9-12	01.0	65000.0	57500	11802	5110	0000053	30,780.00	
223		17-Sep-10	Beach Citites Learning Center	Non Public Agency Services	District-level,9-12	01.0	65000.0	57500	11802	5110	0000053	15,780.00	
224		17-Sep-10	Beach Citites Learning Center	Non Public Agency Services	District-level,9-12	01.0	65000.0	57500	11802	5110	0000053	2,540.00	
225		17-Sep-10	Beach Citites Learning Center	Non Public Agency Services	District-level,9-12	01.0	65000.0	57500	11802	5110	0000053	10,500.00	
226		17-Sep-10	Beach Citites Learning Center	Non Public Agency Services	District-level,9-12	01.0	65000.0	57500	11802	5110	0000053	27,060.00	
227		17-Sep-10	Beach Citites Learning Center	Non Public Agency Services	District-level,9-12	01.0	65000.0	57500	11802	5110	0000053	1,050.00	
228		17-Sep-10	Beach Citites Learning Center	Non Public Agency Services	District-level,9-12	01.0	65000.0	57500	11802	5110	0000053	27,680.00	
229		17-Sep-10	Beach Citites Learning Center	Non Public Agency Services	District-level,9-12	01.0	65000.0	57500	11802	5110	0000053	30,780.00	
230		17-Sep-10	Beach Citites Learning Center	Non Public Agency Services	District-level,9-12	01.0	65000.0	57500	11802	5110	0000053	27,680.00	
231		17-Sep-10	Beach Citites Learning Center	Non Public Agency Services	District-level,9-12	01.0	65000.0	57500	11802	5110	0000053	30,780.00	
232		5-Oct-10	The Center for Learning Unlimited	NONPUBLIC SCHOOLS SERVICE	District-level,9-12	01.0	65000.0	57500	11802	5110	0000053	78,607.25	
233		5-Oct-10	The Center for Learning Unlimited	NONPUBLIC SCHOOLS SERVICE	District-level,9-12	01.0	65000.0	57500	11802	5110	0000053	58,987.25	
234		5-Oct-10	The Center for Learning Unlimited	NONPUBLIC SCHOOLS SERVICE	District-level,9-12	01.0	65000.0	57500	11802	5110	0000053	33,744.25	
235		5-Oct-10	The Center for Learning Unlimited	NONPUBLIC SCHOOLS SERVICE	District-level,9-12	01.0	65000.0	57500	11802	5110	0000053	112,282.00	
236		27-Oct-10	Devereux Cleo Wallace	NONPUBLIC SCHOOLS SERVICE	District-level,9-12	01.0	65000.0	57500	11802	5110	0000053	31,250.00	
237		27-Oct-10	Devereux Glenholme	NONPUBLIC SCHOOLS SERVICE	District-level,9-12	01.0	65000.0	57500	11802	5110	0000053	37,632.00	
238		27-Oct-10	Excelsior Youth Center, Inc.	NONPUBLIC SCHOOLS SERVICE	District-level,9-12	01.0	65000.0	57500	11802	5110	0000053	1,818.00	
239		27-Oct-10	Help Group, The	Non Public Agency Services	District-level,9-12	01.0	65000.0	57500	11802	5110	0000053	47,491.80	
240		27-Oct-10	Help Group, The	Non Public Agency Services	District-level,9-12	01.0	65000.0	57500	11802	5110	0000053	39,391.80	
241		27-Oct-10	Help Group, The	NONPUBLIC SCHOOLS SERVICE	District-level,9-12	01.0	65000.0	57500	11802	5110	0000053	27,891.64	
242		27-Oct-10	Help Group, The	NONPUBLIC SCHOOLS SERVICE	District-level,9-12	01.0	65000.0	57500	11802	5110	0000053	37,776.80	
243		27-Oct-10	Help Group, The	NONPUBLIC SCHOOLS SERVICE	District-level,9-12	01.0	65000.0	57500	11802	5110	0000053	33,292.00	
244		19-Oct-10	Personal Coaching Systems	NONPUBLIC SCHOOLS SERVICE	District-level,9-12	01.0	65000.0	57500	11802	5110	0000053	47,059.50	
245		27-Oct-10	UHS OF PROVO CANYON	NONPUBLIC SCHOOLS SERVICE	District-level,9-12	01.0	65000.0	57500	11802	5110	0000053	37,544.00	
246		20-Sep-10	The Westview School	Non Public Agency Services	District-level,6-8	01.0	65000.0	57500	11802	5110	0000052	35,503.45	
247		20-Sep-10	The Westview School	Non Public Agency Services	District-level,9-12	01.0	65000.0	57500	11802	5110	0000053	35,503.45	
248		20-Sep-10	The Westview School	Non Public Agency Services	District-level,9-12	01.0	65000.0	57500	11802	5110	0000053	30,503.45	
249		20-Sep-10	The Westview School	Non Public Agency Services	District-level,9-12	01.0	65000.0	57500	11802	5110	0000053	35,503.45	
250		27-Oct-10	Help Group, The	NONPUBLIC SCHOOLS SERVICE	District-level,9-12	01.0	65000.0	57500	11802	5110	0000053	50,645.56	
251		27-Oct-10	Help Group, The	NONPUBLIC SCHOOLS SERVICE	District-level,9-12	01.0	65000.0	57500	11802	5110	0000053	16,801.40	
252		5-Oct-10	Autism Behavior Consultants	Non Public Agency Services	District-level,K-5	01.0	65000.0	57500	11801	5110	0000051	38,454.00	
253		5-Oct-10	Autism Behavior Consultants	Non Public Agency Services	District-level,K-5	01.0	65000.0	57500	11801	5110	0000051	69,615.00	
254		20-Sep-10	Autism Spectrum Therapies, Inc.	Non Public Agency Services	District-level,K-5	01.0	65000.0	57500	11801	5110	0000051	32,691.00	
255		22-Sep-10	Behavior and Education, Inc.	Non Public Agency Services	District-level,K-5	01.0	65000.0	57500	11801	5110	0000051	38,301.00	
256		22-Sep-10	Behavior and Education, Inc.	Non Public Agency Services	District-level,K-5	01.0	65000.0	57500	11801	5110	0000051	12,342.00	
257		29-Sep-10	Behavior and Education, Inc.	Non Public Agency Services	District-level,9-12	01.0	65000.0	57500	11801	5110	0000053	2,040.00	
258		22-Sep-10	Behavior and Education, Inc.	Non Public Agency Services	District-level,6-8	01.0	65000.0	57500	11801	5110	0000052	5,916.00	

24